

PALM DESERT GENERAL NOTES:

- ALL WORK SHALL BE DONE IN ACCORDANCE WITH THIS PLAN, THE STANDARD DRAWINGS AND SPECIFICATIONS OF THE CITY OF PALM DESERT, THE STANDARD SPECIFICATIONS FOR PUBLIC WORKS CONSTRUCTION AND THE CALTRANS STANDARD PLANS AND CALTRANS STANDARD SPECIFICATIONS WHEN APPLICABLE.
- NO CONSTRUCTION IS AUTHORIZED WITHOUT THE APPROPRIATE PERMITS ISSUED BY THE CITY OF PALM DESERT.
- THE ENGINEER-OF-WORK SHALL BE NOTIFIED WHEN CONSTRUCTION HAS COMMENCED.
- IN THE EVENT OF DISCREPANCIES AND/OR DEVIATIONS ARISING DURING CONSTRUCTION, THE ENGINEER-OF-WORK SHALL BE RESPONSIBLE FOR DETERMINING AN ACCEPTABLE SOLUTION AND REVISING THE PLANS FOR APPROVAL BY THE CITY ENGINEER.
- THE CONTRACTOR SHALL BE RESPONSIBLE FOR ALL DAMAGES TO ONSITE, OFFSITE AND ADJACENT UTILITIES, FACILITIES AND PROPERTIES.
- THE CONTRACTOR SHALL TAKE ALL NECESSARY AND PROPER PRECAUTIONS TO PROTECT ADJACENT PROPERTY OWNERS FROM ANY AND ALL DAMAGE THAT MAY OCCUR FROM STORM WATER RUNOFF AND/OR DEPOSITION OF DEBRIS RESULTING FROM ANY AND ALL WORK IN CONJUNCTION WITH CONSTRUCTION OF THESE IMPROVEMENT PLANS.
- THE CONTRACTOR, AT NO EXPENSE TO THE CITY, SHALL PROVIDE ALL NECESSARY SAMPLES AND TESTS THAT THE CITY ENGINEER MAY REQUIRE TO ASSURE THAT QUALITY OF MATERIAL AND WORKMANSHIP ARE IN ACCORDANCE WITH THE SPECIFICATIONS.
- THE CONTRACTOR SHALL BE RESPONSIBLE FOR ALL WORK AND SHALL MAINTAIN ALL FACILITIES, COMPLETED AND UNCOMPLETED, UNTIL ACCEPTED BY THE CITY.
- ALL SURVEY MONUMENTS WITHIN OR BOUNDING THE WORK LIMITS, WHETHER FOUND FROM RECORD OR BY INSPECTION, SHALL, PRIOR TO ANY CONSTRUCTION, BE LOCATED AND REFERENCED BY A LICENSED SURVEYOR OR A CIVIL ENGINEER AUTHORIZED TO PRACTICE LAND SURVEYING. THE REFERENCED MONUMENTS DISTURBED OR REMOVED DURING CONSTRUCTION SHALL BE RESET IN ACCORDANCE WITH SECTION 8771 OF THE LAND SURVEYORS ACT AND CITY STANDARDS AND REQUIREMENTS AT THE CONTRACTOR'S EXPENSE.
- THE CONTRACTOR SHALL NOTIFY THE ENGINEERING DIVISION IN PALM DESERT AT (760) 776-6450 AT LEAST 48 HOURS PRIOR TO COMMENCING ANY WORK.
- THE CONTRACTOR SHALL BE RESPONSIBLE FOR THE LOCATION AND PROTECTION OF ALL UTILITIES. FOR THE LOCATION OF UNDERGROUND UTILITIES OR FOR EMERGENCY ASSISTANCE CALL:

WATER SEWER	COACHELLA VALLEY WATER DISTRICT	760-398-2651
ELECTRIC	COACHELLA VALLEY WATER DISTRICT	760-398-2651
GAS	SOUTHERN CALIFORNIA EDISON	760-202-4291
TELEPHONE	THE GAS COMPANY	1-800-427-2200
CABLE	VERIZON CALIFORNIA, INC.	1-800-483-1000
DIG ALERT	TIME WARNER	760-340-1312
		1-800-227-2600

- THE ENGINEERING DIVISION DOES NOT ASSUME ANY RESPONSIBILITY FOR THE ACCURACY OF THE QUANTITIES SHOWN HEREON.
- THE STRUCTURAL SECTION SHALL BE AS PER THE STATE OF CALIFORNIA DEPARTMENT OF TRANSPORTATION, HIGHWAY DESIGN MANUAL TEST NO. 301-F FOR DETERMINATION BY THE R-VALUE METHOD.
- THESE PLANS MAY BE SUBJECT TO REVIEW AND/OR REVISION BY THE CITY OF PALM DESERT ENGINEERING DIVISION, IF CONSTRUCTION HAS NOT COMMENCED WITHIN 12 MONTHS FROM THE DATE OF APPROVAL BY THE CITY ENGINEER.
- ALL P.C.C. AND A.C. REMOVALS SHALL BE OUTLINED TO NECESSARY WORKING LIMITS AND SAWCUT TO A MINIMUM DEPTH OF 2 INCHES PRIOR TO REMOVAL. ALL DEBRIS CREATED BY THE REMOVAL OPERATIONS SHALL BE DISPOSED OF AWAY FROM THE JOB SITE IN A MANNER AND LOCATION ACCEPTABLE TO ALL CONCERNED AGENCIES AND ORGANIZATIONS.
- ALL P.C.C. AND A.C. IMPROVEMENTS DAMAGED BY THE CONTRACTOR'S OPERATIONS SHALL BE RESTORED TO THEIR ORIGINAL CONDITION BY THE CONTRACTOR AT NO COST TO THE CITY OF PALM DESERT.
- STREETS IN THE CONSTRUCTION AREA SHALL BE KEPT CLEAN AT ALL TIMES.
- THE CONTRACTOR SHALL BE RESPONSIBLE FOR CLEARING OF THE PROPOSED WORK AREA.
- NO PUBLIC STREET SHALL BE CLOSED TO TRAFFIC WITHOUT PRIOR WRITTEN APPROVAL OF THE CITY ENGINEER.
- NO TRENCHES SHALL REMAIN OPEN OVERNIGHT WITHOUT PRIOR WRITTEN APPROVAL OF THE CITY ENGINEER.
- FAILURE TO COMPLY WITH ANY OF THE ABOVE ITEMS SHALL BE SUFFICIENT CAUSE FOR THE CITY TO ARRANGE FOR NECESSARY WORK TO BE COMPLETED BY OTHERS. COSTS TO COMPLETE THE WORK BY OTHERS WILL BE CHARGED TO THE CONTRACTOR.
- ALL LANDSCAPING AND IRRIGATION THAT IS DAMAGED BY CONSTRUCTION ACTIVITIES SHALL BE REPAIRED OR REPLACED TO THE APPROVAL OF THE CITY AND THE PROPERTY OWNER.
- CONTRACTOR MUST OBTAIN APPROVAL FOR ANY LANE CLOSURES A MINIMUM OF 48 HOURS IN ADVANCE.
- CONTRACTOR SHALL CALL THE ENGINEERING DIVISION TO REQUEST INSPECTION A MINIMUM OF 24 HOURS PRIOR TO STARTING CONSTRUCTION. CONTRACTOR SHALL KEEP THE INSPECTOR INFORMED OF PROGRESS OF THE WORK ON A DAILY BASIS. IMPROVEMENTS PLACED WITHOUT INSPECTION MAY BE REJECTED AND ARE SUBJECT TO REMOVAL.

IN THE CITY OF PALM DESERT, COUNTY OF RIVERSIDE, STATE OF CALIFORNIA

CIVIC CENTER ADA REVISIONS

PARCEL MAP 37347 (MB 245/100-110)

73510 FRED WARING DRIVE

GRADING GENERAL NOTES

- ALL GRADING TO BE DONE IN ACCORDANCE WITH THE CITY OF PALM DESERT GRADING ORDINANCE.
- THIS PLAN IS FOR GRADING PURPOSES ONLY. ISSUANCE OF A GRADING PERMIT BASED ON THIS PLAN DOES NOT CONSTITUTE APPROVAL OF DRIVEWAY LOCATIONS AND SIZES, PARKING LAYOUT, BUILDING LOCATION, WALL HEIGHTS AND LOCATIONS, OFFSITE DRAINAGE FACILITIES, OR OTHER ITEMS NOT RELATED DIRECTLY TO THE BASIC GRADING OPERATION.
- A LETTER OF CERTIFICATION FROM THE ENGINEER-OF-WORK STATING THAT THE GRADING IS IN SUBSTANTIAL CONFORMANCE WITH THE APPROVED PLAN AND THAT THE PAD ELEVATION/FINISHED FLOOR ELEVATION ARE PER THE APPROVED PLAN, AND A COMPACTION REPORT FROM A SOILS ENGINEER ON ALL FILL AREAS ARE REQUIRED PRIOR TO THE BUILDING PERMIT ISSUANCE.
- ALL WALLS SHOWN ON THESE PLANS SHALL BE APPROVED BY THE DEPARTMENT OF COMMUNITY DEVELOPMENT, ISSUED A SEPARATE PERMIT AND BE INSPECTED BY THE DEPARTMENT OF BUILDING AND SAFETY. THOSE WALLS SHOWN AS RETAINING WALLS SHALL BE CONSTRUCTED TO CITY OF PALM DESERT RETAINING WALL STANDARDS OR BE SUPPORTED BY ENGINEERING CALCULATIONS AND DETAILS.
- THE ENGINEER-OF-WORK SHALL BE NOTIFIED WHEN CONSTRUCTION HAS COMMENCED.
- IN THE EVENT OF DISCREPANCIES AND/OR DEVIATIONS ARISING DURING CONSTRUCTION, THE ENGINEER-OF-WORK SHALL BE RESPONSIBLE FOR DETERMINING AN ACCEPTABLE SOLUTION AND REVISING THE PLANS FOR APPROVAL BY THE ENGINEERING DIVISION.
- THE CONTRACTOR SHALL BE RESPONSIBLE FOR ALL DAMAGES TO ON-SITE, OFF-SITE AND ADJACENT UTILITIES, FACILITIES AND PROPERTIES.
- THE CONTRACTOR SHALL TAKE ALL NECESSARY AND PROPER PRECAUTIONS TO PROTECT ADJACENT PROPERTY OWNERS FROM ANY AND ALL DAMAGE THAT MAY OCCUR FROM STORM WATER RUNOFF AND/OR DEPOSITION OF DEBRIS RESULTING FROM ANY AND ALL WORK IN CONJUNCTION WITH CONSTRUCTION OF THESE GRADING PLANS.
- THE CONTRACTOR SHALL NOTIFY THE ENGINEERING DIVISION (760) 776-6450 AT LEAST 24 HOURS PRIOR TO COMMENCING ANY WORK.
- THE CONTRACTOR SHALL BE RESPONSIBLE FOR THE LOCATION AND PROTECTION OF ALL UTILITIES. FOR THE LOCATION OF UNDERGROUND UTILITIES, OR FOR EMERGENCY ASSISTANCE CALL:

SOUTHERN CALIFORNIA EDISON	1-800-227-2600
THE GAS COMPANY	1-800-227-2600
FRONTIER	1-888-669-9034
COACHELLA VALLEY WATER DISTRICT	1-760-398-2651
SPECTRUM	1-855-986-4919

- ALL PROPERTY CORNER MONUMENTS SHALL NOT BE DISTURBED BY THE GRADING OPERATION AND RELATED WORK. ANY MONUMENT WHICH THE CONTRACTOR ANTICIPATES DISTURBING SHALL BE LOCATED AND REFERENCED BY A LICENSED LAND SURVEYOR OR A CIVIL ENGINEER AUTHORIZED TO PRACTICE LAND SURVEYING. ALL MONUMENTS DISTURBED OR REMOVED SHALL BE RESET BY A LICENSED SURVEYOR, OR A CIVIL ENGINEER AUTHORIZED TO PRACTICE LAND SURVEYING, AT THE CONTRACTOR'S EXPENSE.
- THESE PLANS MAY BE SUBJECT TO REVIEW AND/OR REVISION BY THE CITY OF PALM DESERT ENGINEERING DIVISION, IF CONSTRUCTION HAS NOT COMMENCED WITHIN 12 MONTHS FROM THE DATE OF APPROVAL BY CITY ENGINEER.

PAVING NOTES

- ALL UNDERGROUND FACILITIES, INCLUDING LATERALS, SHALL BE IN PLACE, AND ALL TRENCHES COMPACTED AND TESTED PRIOR TO PAVING.
- ALL EXISTING OR NEW IMPROVEMENTS, INCLUDING CURB AND GUTTERS, SIDEWALKS, ASPHALT CONCRETE OR P.C.C. PAVING, WHICH ARE BEING JOINED OR MATCHED IN CONNECTION WITH THIS PROJECT SHALL BE JOINED OR MATCHED IN A MANNER SATISFACTORY TO THE CITY ENGINEER, INCLUDING NECESSARY SAWCUTTING, REMOVAL, REPLACEMENT AND CAPPING.
- NEW OR EXISTING CURB AND GUTTER SHALL BE MARKED AT EVERY 10 FEET WITH A SCORE LINE AND EVERY 50 FEET WITH A CONSTRUCTION EXPANSION JOINT.
- NEW OR EXISTING CURB AND GUTTER SHALL BE JOINED, MATCHED, OR REPLACED IF DAMAGED, TO A SAWCUT LINE SUCH THAT A MINIMUM LENGTH OF 7 FEET OR CURB AND GUTTER REMAINS IN PLACE AT ALL LOCATIONS.
- A "TACK COAT" SHALL BE APPLIED BETWEEN PAVEMENT LAYERS, CONCRETE SURFACES AND ON EXISTING PAVEMENT TO BE RESURFACED AT THE RATE OF 0.10 GAL/YD. THE TACK COAT SHALL BE TYPE SS1 ASPHALTIC EMULSION WITH A 60-70 GRADE LIQUID ASPHALT.
- THE VISCOSITY GRADE OF PAVING ASPHALT SHALL BE AR-4000 OR AS DETERMINED BY THE CITY ENGINEER AT THE TIME OF PAVING.
- THE FINAL OR SURFACE LAYER OF ASPHALT CONCRETE SHALL NOT BE PLACED UNTIL ALL ON-SITE IMPROVEMENTS HAVE BEEN COMPLETED, INCLUDING ALL EARTHWORK GRADING.
- MANHOLES AND VALVE BOX FRAMES SHALL BE ADJUSTED TO FINISHED GRADES AFTER COMPLETION OF CONSTRUCTION TO THE STANDARDS OF THE FACILITY OWNER.
- ALL EXISTING PAVEMENT WITHIN AND ADJOINING THIS PROJECT SHALL BE EITHER REMOVED OR STRUCTURALLY TESTED TO VERIFY THAT THE STRUCTURAL CAPABILITIES ARE ACCEPTABLE. ALL RESULTS SHALL BE APPROVED BY THE CITY ENGINEER.
- THE CURB SHALL BE "ETCHED" SHOWING LATERAL LOCATIONS: 'S' FOR SEWER, 'G' FOR GAS, AND 'E' FOR ELECTRICAL.
- ALL PERMANENT ROADWAY TRAFFIC STRIPING, LEGENDS AND PAVEMENT MARKERS SHALL BE INSTALLED AFTER PERMANENT PAVING. THE TYPE AND LOCATIONS SHALL BE INSTALLED PER PLAN OR AS DIRECTED BY THE CITY ENGINEER.
- TEMPORARY ROADWAY STRIPING SHALL BE INSTALLED ON ALL UNFINISHED ROADWAY SURFACES AS DIRECTED BY THE CITY ENGINEER.

EXISTING UNDERGROUND UTILITIES

SANITARY SEWER	8" S	TELEPHONE CONDUIT	T
WATER LINE	6" W	ELECTRICAL CONDUIT	E
STORM DRAIN	24" S.D.	STREET LIGHTING	SL
GAS LINE	2" G	TRAFFIC SIGNAL	SIG
IRRIGATION LINE	20" IRR.	CABLE TELEVISION	CTV

EXISTING TOPOGRAPHY

	BLOCK WALL		TOP OF SLOPE
	BOARD FENCE		TOE OF SLOPE
	WIRE FENCE		DIRECTION OF FLOW
	CHAIN LINK FENCE		RETAINING WALL
	SANITARY SEWER M.H.		POLE & GUY ANCHOR
	STORM DRAIN M.H.		ELECTRICAL POLE
	TELEPHONE VAULT		TELEPHONE POLE
	JOINT USE POLE		TRAFFIC SIGN
	WATER METER		STREET NAME SIGN
	FIRE HYDRANT		MAIL BOX
	SANITARY SEWER CLEANOUT		PEDESTRIAN PUSH BUTTON
	STREET LIGHT (UPRIGHT)		TRAFFIC SIGNAL CONTROLLER
	TRAFFIC SIGNAL		TRAFFIC SIGNAL ON SIGNAL MAST ARM
	STREET LIGHT & TRAFFIC SIGNAL ON MAST ARM		CITRUS TREE
	WALK - DON'T WALK PEDESTRIAN SIGNAL		DECIDUOUS TREE
	CONCRETE		PALM TREE
	ASPHALT		TREE STUMP
	EDGE OF PAVEMENT		SHRUBBERY
	BUILDING		
	UNDERGROUND STRUCTURE		
	OVERHANGING STRUCTURE		
	REMOVAL		

LEGEND

FINISHED SURFACE	FS
HIGH POINT	HP
LOW POINT	LP
GRADE BREAK	GB
INVERT	INV
TOP OF WALL	TW
PAD ELEVATION	PE
FINISHED FLOOR ELEVATION	FF
FLOWLINE	FL
PROPERTY LINE	PL
CLEAN OUT	C.O.
TOP OF CURB	TC
TOP OF FOOTING	TF
FINISHED GRADE	FG
TOP OF GRATE	TG
END OF PAVEMENT	EP
(XXX.XX)	EXIST. ELEV.
RIGHT OF WAY	R/W
PLANTER AREA	P.A.
WATER METER	WM
SEWER LATERAL	SL
CORRUGATED PLASTIC PIPE	CPP
PUBLIC UTILITY EASEMENT	
SETBACK LINE	
FLOW GRADE	
TOP OF SLOPE	
TOE OF SLOPE	
EXISTING SEWER LINE	S
EXISTING WATER LINE	W
BLOCK WALL	
BLOCK RETAINING WALL	
CONCRETE	

SHEET INDEX

- SHEET 1 - TITLE SHEET
- SHEET 2 - OVERALL SITE/ DEMOLITION PLAN
- SHEET 3 - ADA RAMP & CURB REPLACEMENT
- SHEET 4 - DETAILS

PROJECT INFO

PROJECT:
PALM DESERT CIVIC CENTER
ADA UPDATES
73510 FRED WARING DRIVE
PALM DESERT, CA 92260

PROJECT DATA:
TOTAL LOT AREA: 58.65 AC
DISTURBED AREA: 1,000 SF (0.02 AC)
BUILDING TYPE: N/A
BUILDING AREA: N/A
PRIVATE LANDSCAPE AREA: N/A
PUBLIC LANDSCAPE AREA: N/A

FEMA FLOOD DATA:
FLOOD ZONE: NOT IN A DESIGNATED AREA
PANEL: 06065C220H
REV. DATE: APRIL 19, 2017
ZONE DEFINITION: N/A

TOPOGRAPHIC AND BOUNDARY SURVEY:
PROVIDED BY EGAN CIVIL INC
DATED MAY 4, 2023

EARTHWORK QUANTITIES:
RAW CUT: N/A
RAW FILL: N/A
IMPORT: 0 C.Y.
EXPORT: 0 C.Y.

THE QUANTITIES SHOWN ON THIS PLAN ARE FOR THE PURPOSES OF OBTAINING A PERMIT ONLY! THE CONTRACTOR IS RESPONSIBLE FOR THEIR OWN QUANTITIES FOR BIDDING PURPOSES!

APN AND LEGAL DESCRIPTION:
622-250-014
PARCEL MAP 37347
MAP BOOK 245 PAGES 100-110

CIVIL ENGINEER:
BENJAMIN EGAN
EGAN CIVIL INC
46-150 COMMERCE STREET, SUITE 100
INDIO, CA 92201
PHONE: (760) 404-7663

OWNER:
CITY OF PALM DESERT
C/O: RYAN LAMB
73510 FRED WARING DRIVE
PALM DESERT, CA 92260

REFERENCE DATA:
PARCEL MAP 37347, MB 245/100-110

**ANY MODIFICATION OF THIS PLAN
MUST BE APPROVED BY THE CITY
PRIOR TO CONSTRUCTION**

CITY PERMIT #: _____

CITY ISSUE DATE: _____

FOR CITY USE ONLY

<p>DIG ALERT</p> <p>Dig Safely</p> <p>811</p> <p>AT LEAST TWO DAYS BEFORE YOU DIG UNDERGROUND SERVICE ALERT OF SOUTHERN CALIFORNIA</p>	<p>BENCHMARK PD BM #141</p> <p>ELEVATION 185.78 DATUM NAVD 88</p> <p>LOCATION 2" BRASS DISK ON CURB OF RIDGE VIEW WAY ISLAND AT PCC STATION 1+78.89 AS SHOWN ON CITY OF PALM DESERT STREET & STORM DRAIN IMPROVEMENT PLANS FOR IRONWOOD COUNTRY CLUB TRACT NO. 29713, SHEET B OF 17 ON FILE IN THE OFFICE OF CITY ENGINEER OF THE CITY OF PALM DESERT AS PLAN NO. E-875-B.</p> <p>BASIS OF BEARINGS</p> <p>BEARINGS SHOWN HEREON ARE BASED ON THE CENTERLINE OF RIDGE VIEW WAY OF TRACT NO. 29713, AS SHOWN BY A MAP ON FILE IN BOOK 349, PAGES 12 THROUGH 22 INCLUSIVE OF MAPS, RECORDS OF THE COUNTY OF RIVERSIDE, STATE OF CALIFORNIA, BEING NORTH 39°26'02" WEST</p>	<table border="1"> <tr> <th>ENGINEER</th> <th>MARK</th> <th>BY</th> <th>DATE</th> </tr> <tr> <td> </td> <td> </td> <td> </td> <td> </td> </tr> </table>	ENGINEER	MARK	BY	DATE					<table border="1"> <tr> <th>CITY</th> <th>REVISIONS</th> </tr> <tr> <td> </td> <td> </td> </tr> </table>	CITY	REVISIONS			<p>DESIGNED BY BDE</p> <p>DRAWN BY SPE</p> <p>CHECKED BY BDE</p>		<p>EGAN CIVIL, INC.</p> <p>PO BOX 5282 LA QUINTA, CA 92248-5282 (760) 404-7663 WWW.EGANCIVIL.COM</p> <p>PREPARED UNDER THE DIRECT SUPERVISION OF:</p> <p>BENJAMIN DANIEL EGAN, R.C.E. NO. 73070 DATE 12/05/2023</p>	<p>CITY OF PALM DESERT DEPARTMENT OF DEVELOPMENT SERVICES</p> <p>APPROVED BY: </p> <p>MICHAEL S. ROWE, P.E. CITY ENGINEER R.C.E. 56069, EXP. 12/31/2024</p> <p>REVIEWED AND RECOMMENDED BY: _____ DATE _____</p>	<p>PLAN CHECKED BY:</p> <p>CIVIL</p> <p>TRAFFIC</p> <p>LANDSCAPE</p>	<p>CITY OF PALM DESERT</p> <p>73510 FRED WARING DRIVE, PALM DESERT, CA 92260</p> <p>CIVIC CENTER ADA REVISIONS</p> <p>TITLE SHEET</p> <p>PARCEL MAP NO. 37347 (MAP BOOK 245, PGS. 100-110)</p>	<p>SHEET 1 OF SHEETS 4</p> <p>CITY FILE NUMBER MPL00001</p>
	ENGINEER	MARK	BY	DATE																		
CITY	REVISIONS																					

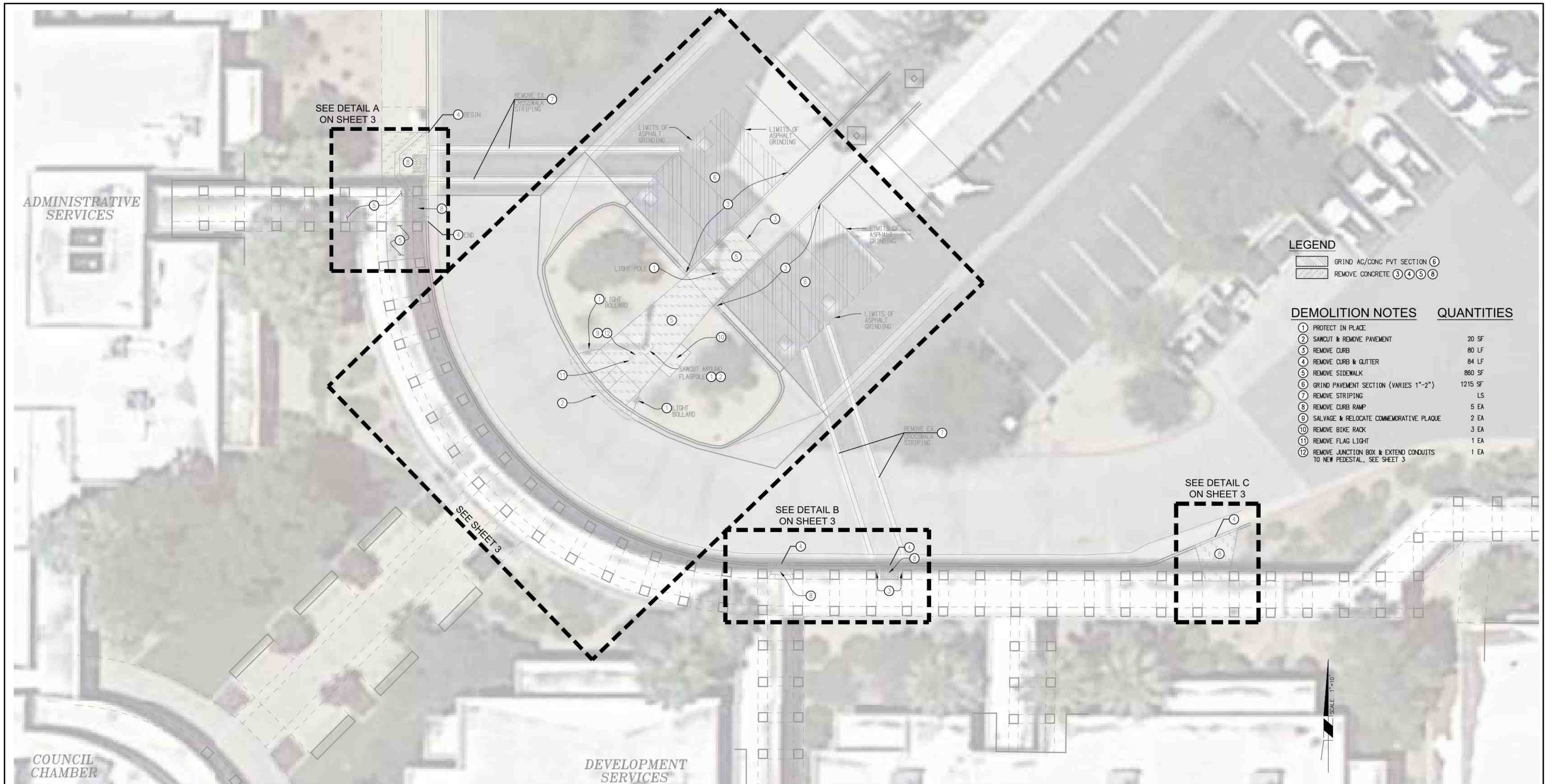

LEGEND

	GRIND AC/CONC PVT SECTION ⑥
	REMOVE CONCRETE ③④⑤⑧

DEMOLITION NOTES	QUANTITIES
① PROTECT IN PLACE	
② SAWCUT & REMOVE PAVEMENT	20 SF
③ REMOVE CURB	80 LF
④ REMOVE CURB & GUTTER	84 LF
⑤ REMOVE SIDEWALK	880 SF
⑥ GRIND PAVEMENT SECTION (VARIES 1"-2")	1215 SF
⑦ REMOVE STRIPING	LS
⑧ REMOVE CURB RAMP	5 EA
⑨ SALVAGE & RELOCATE COMMEMORATIVE PLAQUE	2 EA
⑩ REMOVE BIKE RACK	3 EA
⑪ REMOVE FLAG LIGHT	1 EA
⑫ REMOVE JUNCTION BOX & EXTEND CONDUITS TO NEW PEDESTAL, SEE SHEET 3	1 EA

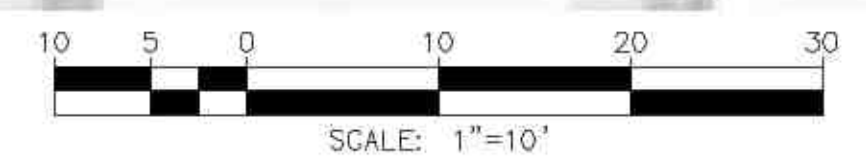

<p>DIG ALERT DIAL TOLL FREE 811 AT LEAST TWO DAYS BEFORE YOU DIG UNDERGROUND SERVICE ALERT OF SOUTHERN CALIFORNIA</p>	<p>BENCHMARK PD BM #141 ELEVATION 185.78 DATUM NAVD 88 LOCATION 2" BRASS DISK ON CURB OF RIDGE VIEW WAY ISLAND AT PCC STATION 14+78.85 AS SHOWN ON CITY OF PALM DESERT STREET & STORM DRAIN IMPROVEMENT PLANS FOR IRONWOOD COUNTRY CLUB TRACT NO. 29713, SHEET B OF 17 ON FILE IN THE OFFICE OF CITY ENGINEER OF THE CITY OF PALM DESERT AS PLAN NO. E-875-B. BASIS OF BEARINGS BEARINGS SHOWN HEREON ARE BASED ON THE CENTERLINE OF RIDGE VIEW WAY OF TRACT NO. 29713, AS SHOWN BY A MAP ON FILE IN BOOK 349, PAGES 12 THROUGH 22 INCLUSIVE OF MAPS, RECORDS OF THE COUNTY OF RIVERSIDE, STATE OF CALIFORNIA, BEING: NORTH 39°26'02" WEST</p>	<table border="1" style="width:100%; border-collapse: collapse;"> <thead> <tr> <th>ENGINEER</th> <th>MARK</th> <th>BY</th> <th>DATE</th> </tr> </thead> <tbody> <tr><td> </td><td> </td><td> </td><td> </td></tr> <tr><td> </td><td> </td><td> </td><td> </td></tr> <tr><td> </td><td> </td><td> </td><td> </td></tr> <tr><td> </td><td> </td><td> </td><td> </td></tr> </tbody> </table>	ENGINEER	MARK	BY	DATE																	<table border="1" style="width:100%; border-collapse: collapse;"> <thead> <tr> <th>REVISIONS</th> <th>APPR</th> <th>DATE</th> </tr> </thead> <tbody> <tr><td> </td><td> </td><td> </td></tr> <tr><td> </td><td> </td><td> </td></tr> <tr><td> </td><td> </td><td> </td></tr> <tr><td> </td><td> </td><td> </td></tr> </tbody> </table>	REVISIONS	APPR	DATE													<table border="1" style="width:100%; border-collapse: collapse;"> <thead> <tr> <th>CITY</th> <th>DESIGNED BY</th> </tr> </thead> <tbody> <tr> <td> </td> <td>BDE</td> </tr> <tr> <td> </td> <td>DRAWN BY</td> </tr> <tr> <td> </td> <td>SPE</td> </tr> <tr> <td> </td> <td>CHECKED BY</td> </tr> <tr> <td> </td> <td>BDE</td> </tr> </tbody> </table>	CITY	DESIGNED BY		BDE		DRAWN BY		SPE		CHECKED BY		BDE		<p>EGAN CIVIL, INC. PO BOX 5282 LA QUINTA, CA 92248-5282 (760) 404-7663 WWW.EGANCIVIL.COM PREPARED UNDER THE DIRECT SUPERVISION OF: <i>Benjamin Daniel Egan</i> 12/05/2023 BENJAMIN DANIEL EGAN, R.C.E. NO. 73070 DATE</p>	<p>CITY OF PALM DESERT DEPARTMENT OF DEVELOPMENT SERVICES APPROVED BY: <i>Michael S. Rowe</i> MICHAEL S. ROWE, P.E. CITY ENGINEER R.C.E. 06069, EXP. 12/31/2024 REVIEWED AND RECOMMENDED BY: DATE</p>	<table border="1" style="width:100%; border-collapse: collapse;"> <thead> <tr> <th>PLAN CHECKED BY:</th> </tr> </thead> <tbody> <tr> <td>CIVIL</td> </tr> <tr> <td>TRAFFIC</td> </tr> <tr> <td>LANDSCAPE</td> </tr> </tbody> </table>	PLAN CHECKED BY:	CIVIL	TRAFFIC	LANDSCAPE		<p>CITY OF PALM DESERT 73510 FRED WARING DRIVE, PALM DESERT, CA 92260 CIVIC CENTER ADA REVISIONS OVERALL SITE/ DEMOLITION PLAN PARCEL MAP NO. 37437 (MAP BOOK 245, PGS. 100-110)</p>	<p>SHEET 2 OF SHEETS 4 CITY FILE NUMBER MPL00001</p>
ENGINEER	MARK	BY	DATE																																																											
REVISIONS	APPR	DATE																																																												
CITY	DESIGNED BY																																																													
	BDE																																																													
	DRAWN BY																																																													
	SPE																																																													
	CHECKED BY																																																													
	BDE																																																													
PLAN CHECKED BY:																																																														
CIVIL																																																														
TRAFFIC																																																														
LANDSCAPE																																																														

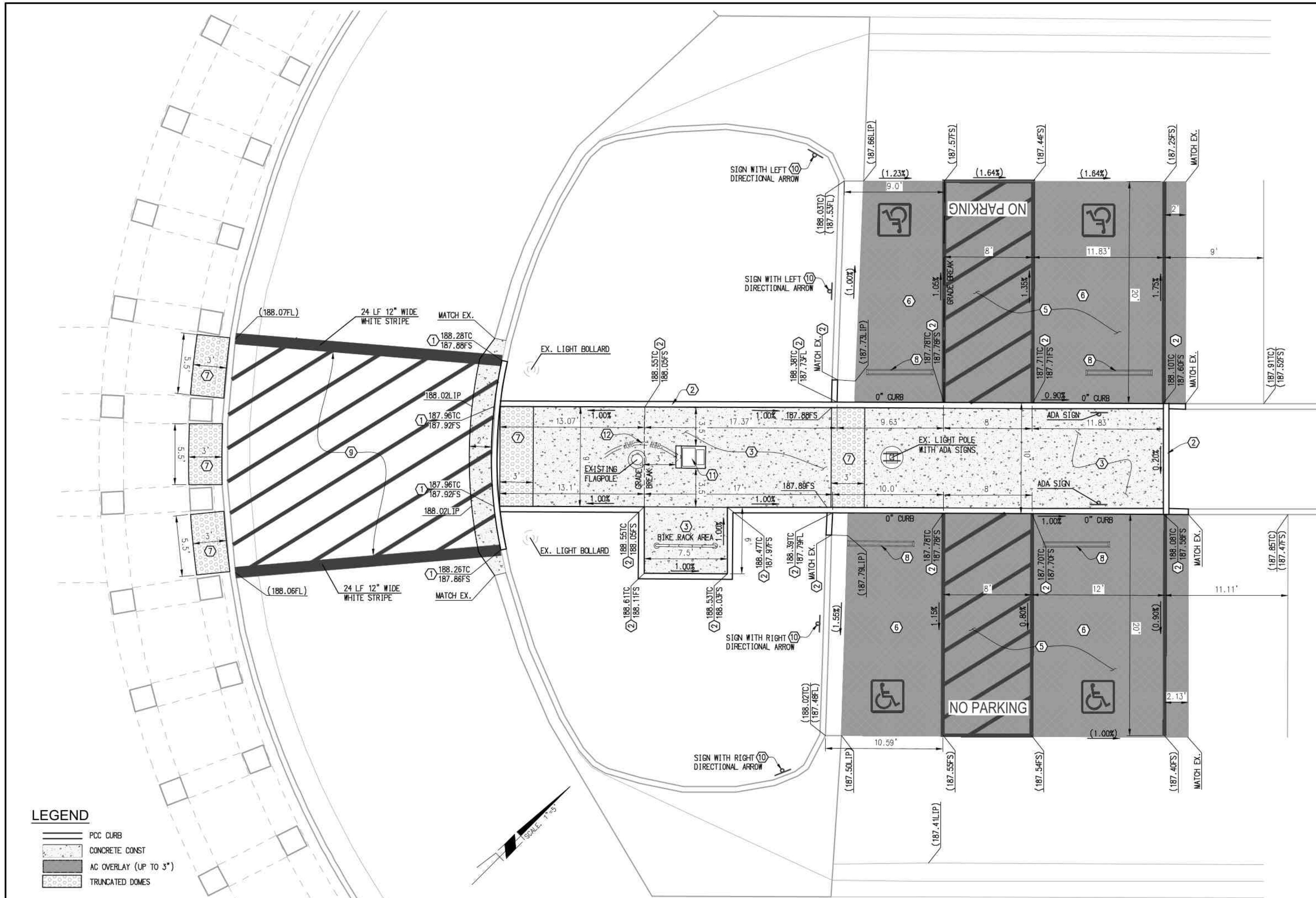

- LEGEND**
- PCC CURB
 - CONCRETE CONST
 - AC OVERLAY (UP TO 3")
 - TRUNCATED DOMES

- CONSTRUCTION NOTES**
- 1) CONSTRUCT 6" PCC CURB & GUTTER PER CITY OF PALM DESERT STD. DWG NO. 102
 - 2) CONSTRUCT 6" PCC CURB PER CITY OF PALM DESERT STD. DWG NO. 103
 - 3) CONSTRUCT SIDEWALK, WIDTH PER PLAN, PER CITY OF PALM DESERT STD. DWG NO. 104
 - 4) CONSTRUCT 4" PCC CONCRETE SIDEWALK OVER 2" COMPACTED SAND, COLOR AND FINISH TO MATCH EXISTING SITE FEATURES
 - 5) AC OVERLAY (VARIES 1"-3")
 - 6) CONSTRUCT STRIPING AND SIGNAGE FOR ACCESSIBLE PARKING SPACE, REF. ACCESSIBLE PARKING DETAIL, SHEET 4.
 - 7) INSTALL DETECTABLE WARNING STRIP (TRUNCATED DOMES) PER DETAIL ON SHEET 4
 - 8) INSTALL CONCRETE WHEEL STOP PER DETAIL ON SHEET 4
 - 9) PAINT 12" WIDE SOLID WHITE STRIPES FOR CROSSWALK LIMITS PER CALTRANS STD PLAN A24F, PAINT 4" WIDE ANGLED LADDER STRIPES THROUGH CROSSWALK AREA
 - 10) INSTALL ACCESSIBLE ROUTE SIGN WITH DIRECTIONAL ARROW PER DETAIL ON SHEET 4
 - 11) CONSTRUCT PEDESTAL FOR COMMEMORATIVE PLAQUES WITH LED FLAG LIGHT PER DETAIL ON SHEET 4
 - 12) EXTEND CONDUITS TO PEDESTAL WITH FLAG LIGHT
- QUANTITIES**
- | |
|---------|
| 63 LF |
| 154 LF |
| 584 SF |
| 320 SF |
| 1215 SF |
| 4 EA |
| 105 SF |
| 4 EA |
| 1 LS |
| 4 EA |
| 1 EA |
| 10 LF |

NOTE: THE QUANTITIES ABOVE ARE PROVIDED FOR INFORMATIONAL PURPOSES ONLY. THE GENERAL CONTRACTOR IS RESPONSIBLE FOR PERFORMING THEIR OWN TAKE-OFF.

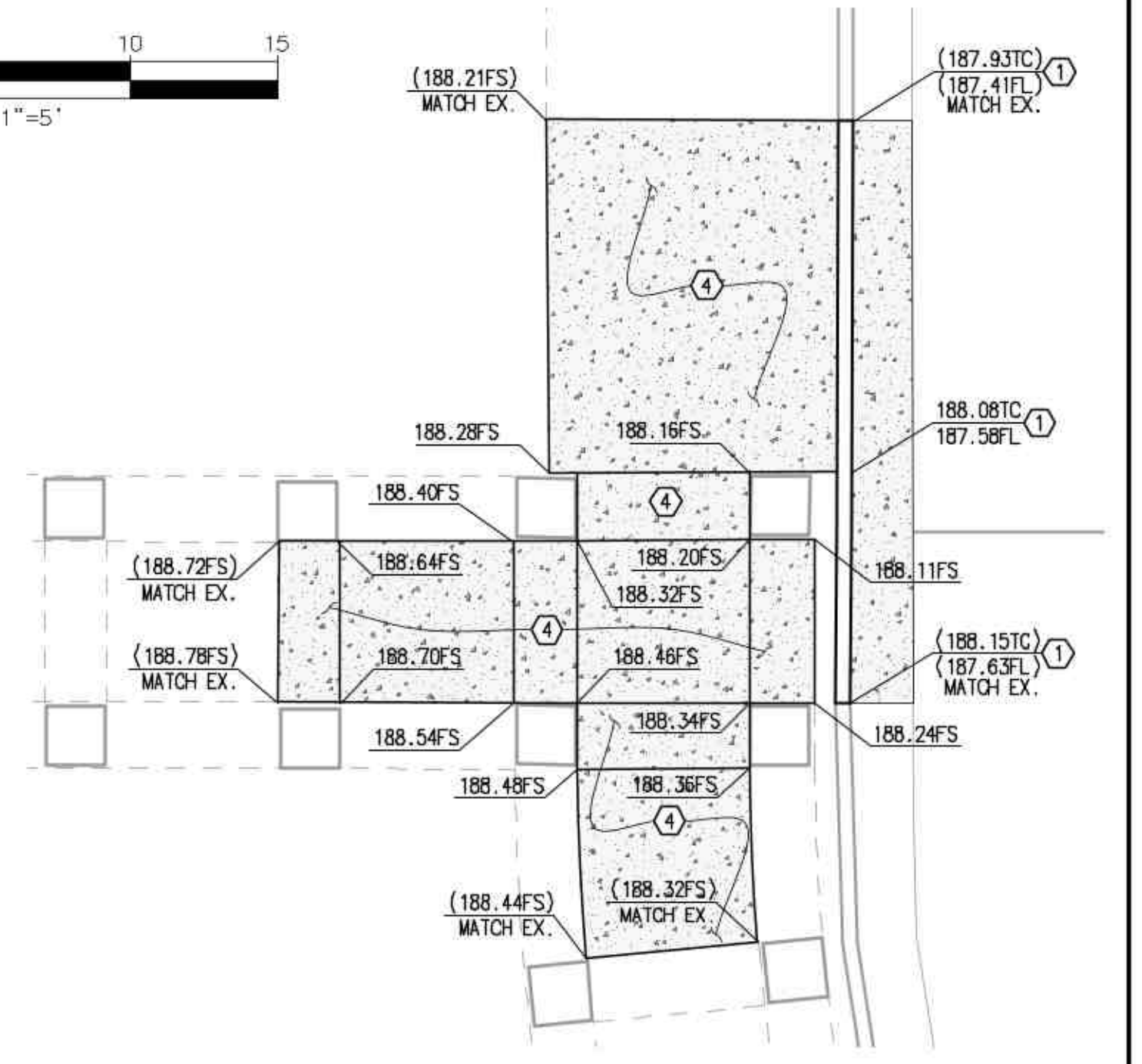
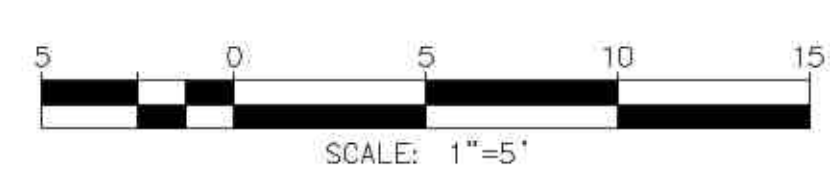
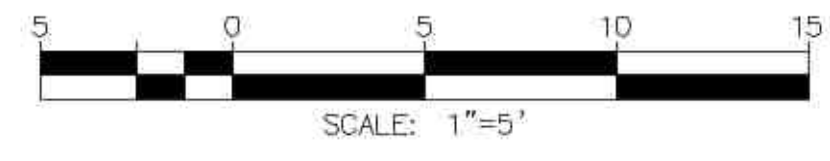

DETAIL A

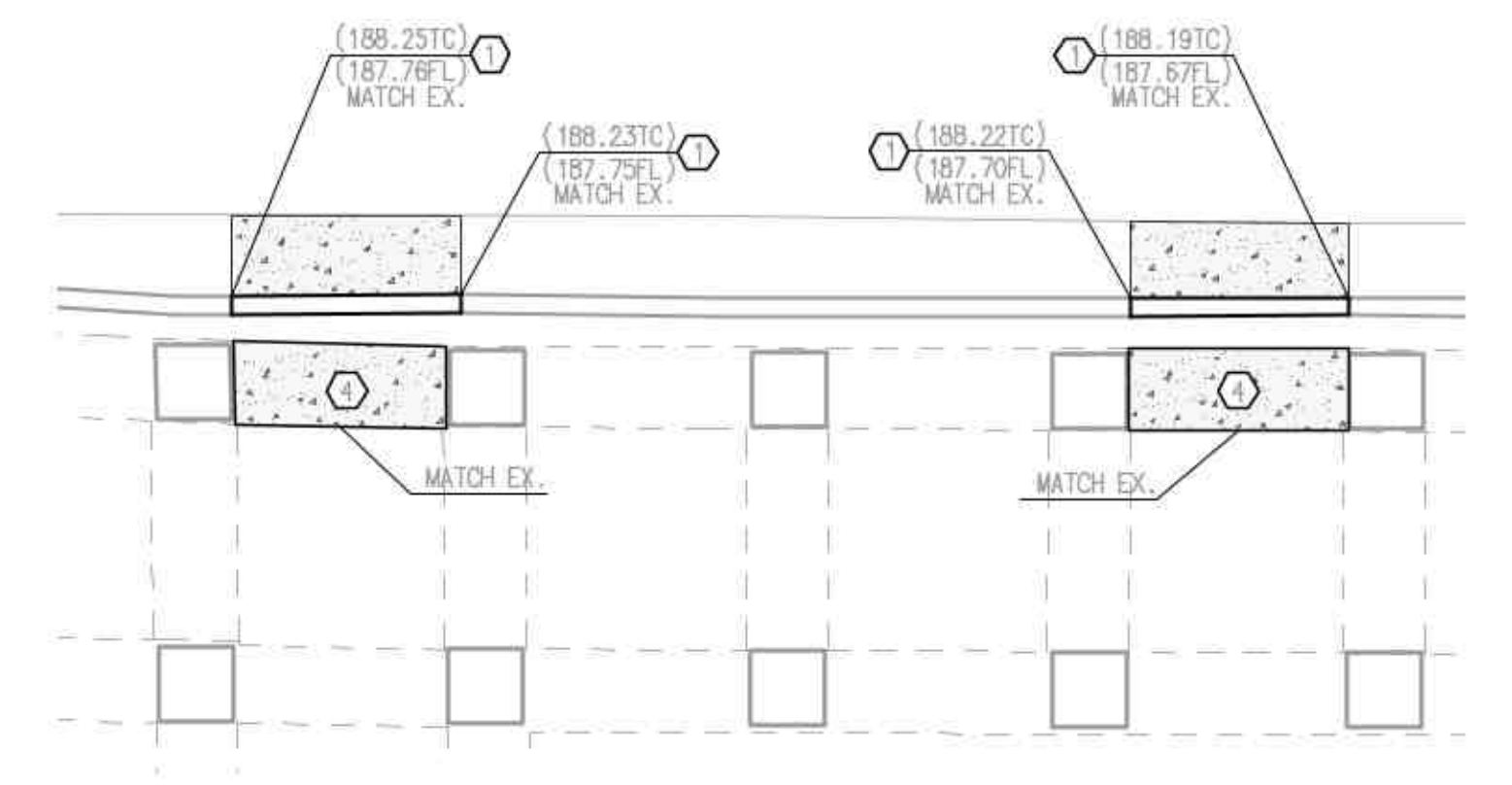
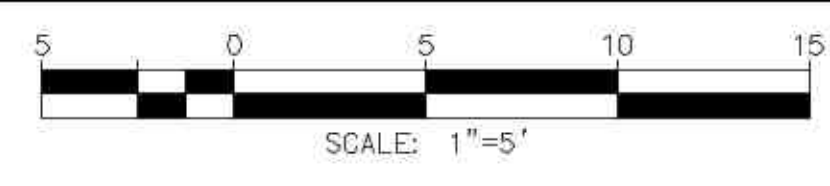

DETAIL B

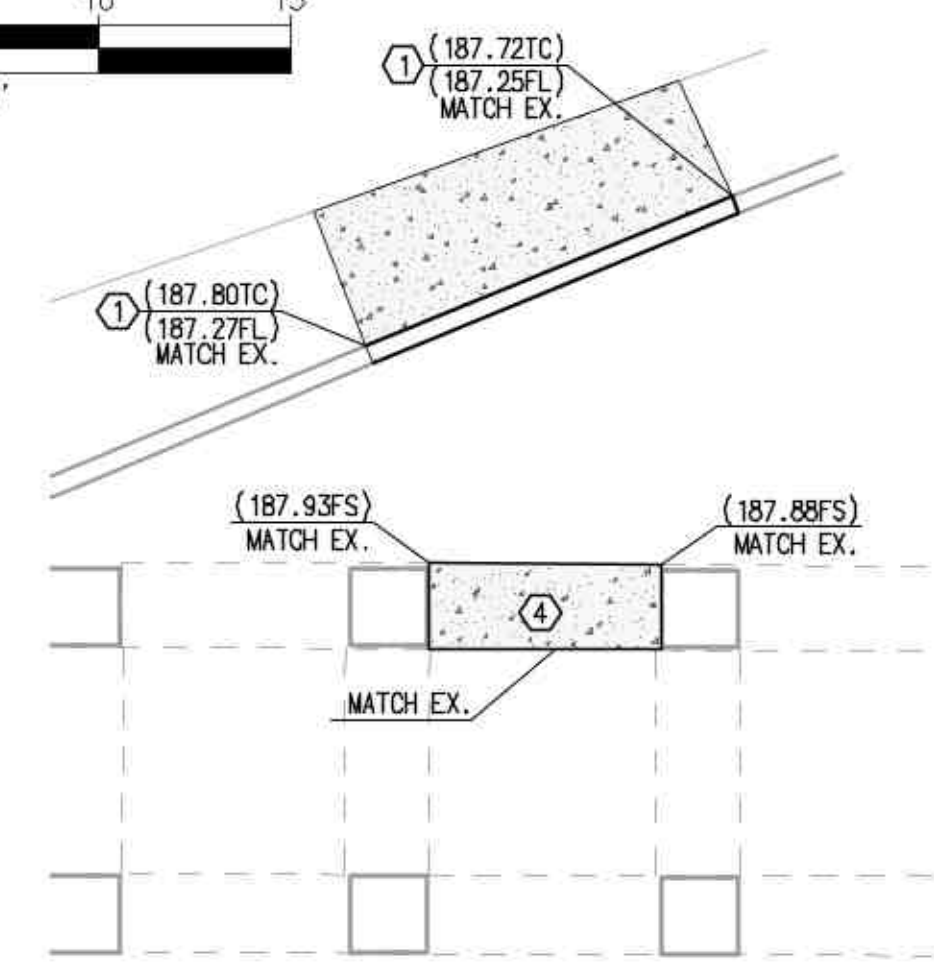
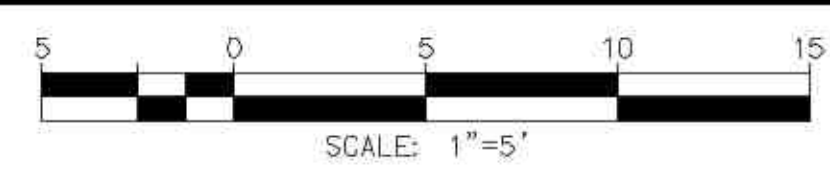

DETAIL C

<p>DIG ALERT 811 AT LEAST TWO DAYS BEFORE YOU DIG UNDERGROUND SERVICE ALERT OF SOUTHERN CALIFORNIA</p>	<p>BENCHMARK PD BM #141 ELEVATION 185.78 DATUM NAVD 88</p>	<p>ENGINEER MARK BY DATE</p>	<p>REVISIONS</p>	<p>CITY APPR DATE</p>	<p>DESIGNED BY BDE</p>	<p>DRAWN BY SPE</p>	<p>CHECKED BY BDE</p>		<p>EGAN CIVIL, INC. PO BOX 5282 LA QUINTA, CA 92448-5282 (760) 404-7663 WWW.EGANCIVIL.COM</p>	<p>CITY OF PALM DESERT DEPARTMENT OF DEVELOPMENT SERVICES APPROVED BY: <i>[Signature]</i> CITY ENGINEER MICHAEL S. ROWE, P.E. R.C.E. 56069, EXP. 12/31/2024</p>	<p>PLAN CHECKED BY: CIVIL TRAFFIC LANDSCAPE</p>		<p>CITY OF PALM DESERT 73510 FRED WARING DRIVE, PALM DESERT, CA 92260 CIVIC CENTER ADA REVISIONS ADA RAMP & CURB REPLACEMENT</p>	<p>SHEET 3 OF SHEETS 4</p> <p>CITY FILE NUMBER MPL00001</p>
---	---	---	-------------------------	----------------------------------	-----------------------------------	--------------------------------	----------------------------------	--	--	---	--	--	---	---

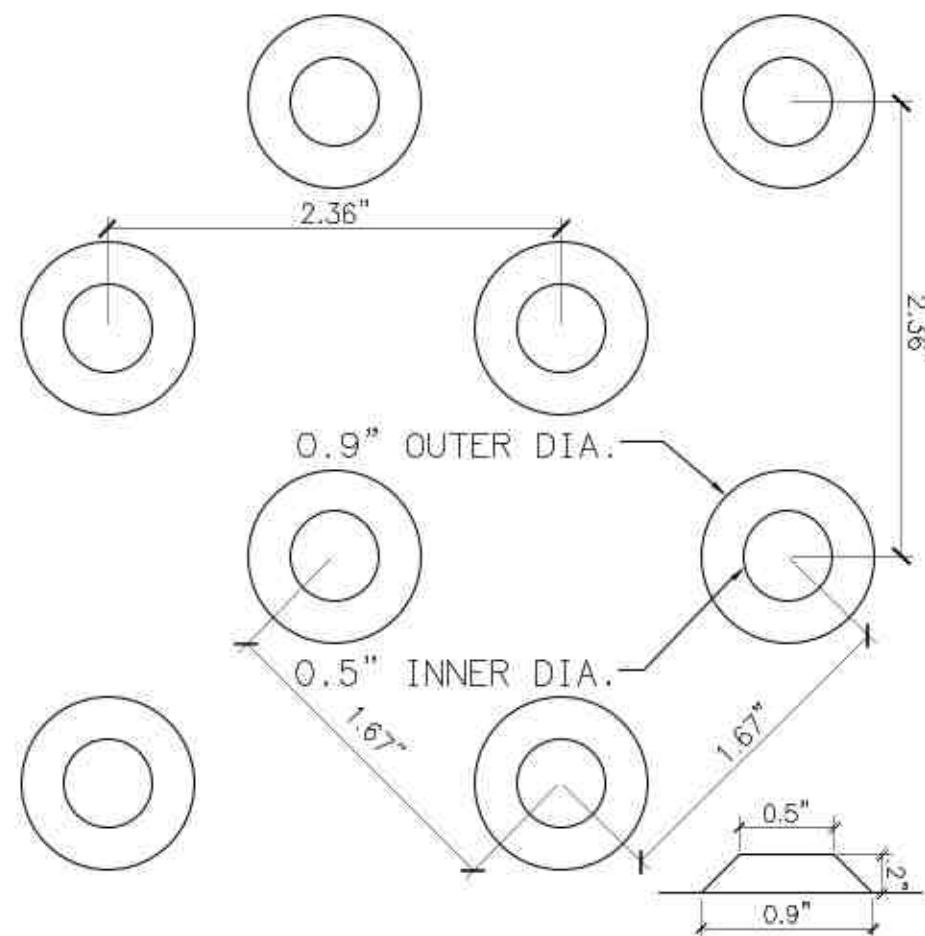

NOTE: THE CONTRACTOR SHALL USE CAST-IN-PLACE, REPLACEABLE TRUNCATED DOMES MANUFACTURED BY ACCESS TILE, ALERTCAST, EQUALTILE, OR APPROVED EQUAL (FEDERAL YELLOW).

1 TRUNCATED DOMES

NTS

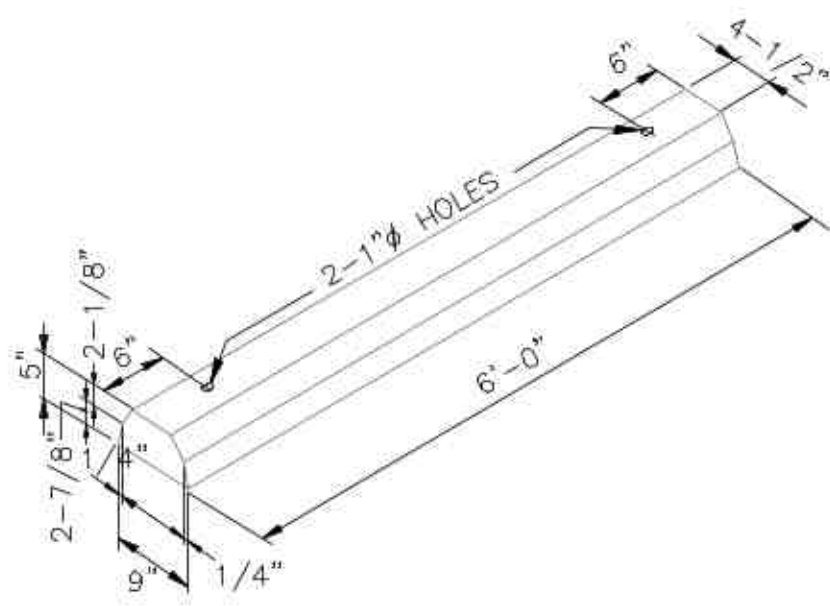
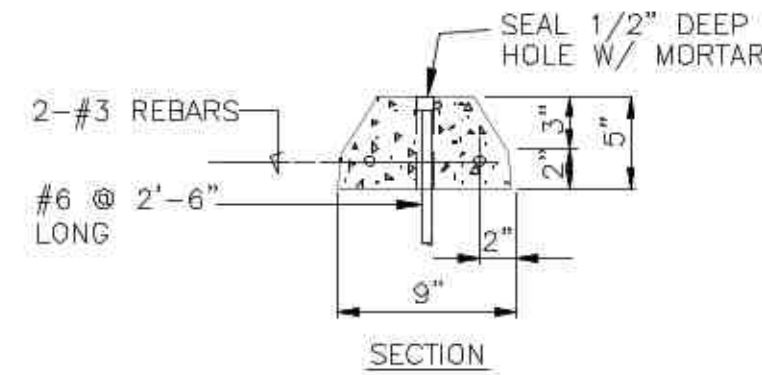

2 CONCRETE WHEELSTOP DETAIL

NTS

NOTE: AREA OF SIGN TO BE A MINIMUM OF 70" SQ. INCHES. DESIGNATE FOR "VAN ACCESSIBLE" WHERE APPROPRIATE.

THE WORDS "NO PARKING" SHALL BE PAINTED ON THE GROUND WITHIN EACH LOADING AND UNLOADING ACCESS AISLE (IN WHITE LETTERS NO LESS THAN 12" HIGH AND LOCATED SO THAT IT IS VISIBLE TO TRAFFIC ENFORCEMENT OFFICIALS) PER SEC.1129B.4.2

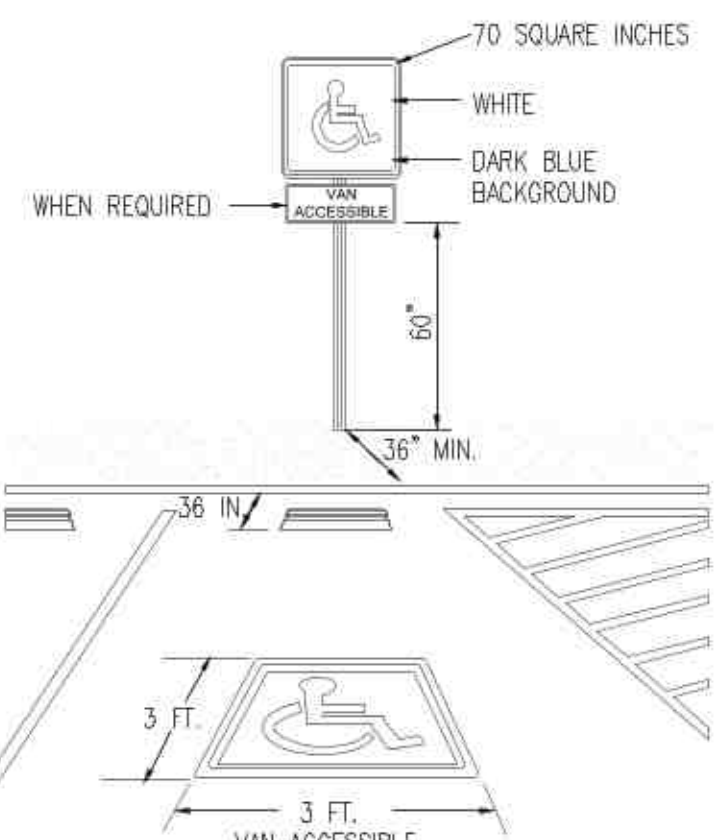

ENTRANCE SIGNS: ALL BUILDINGS THAT ARE ACCESSIBLE TO AND USABLE BY PERSONS WITH DISABILITIES SHALL BE IDENTIFIED WITH AT LEAST ONE STANDARD SIGN AND WITH ADDITIONAL DIRECTIONAL SIGNS AS REQUIRED, TO BE VISIBLE TO PERSONS ALONG APPROACHING PEDESTRIAN WAYS.

3 SIGNAGE REQUIREMENTS

NTS

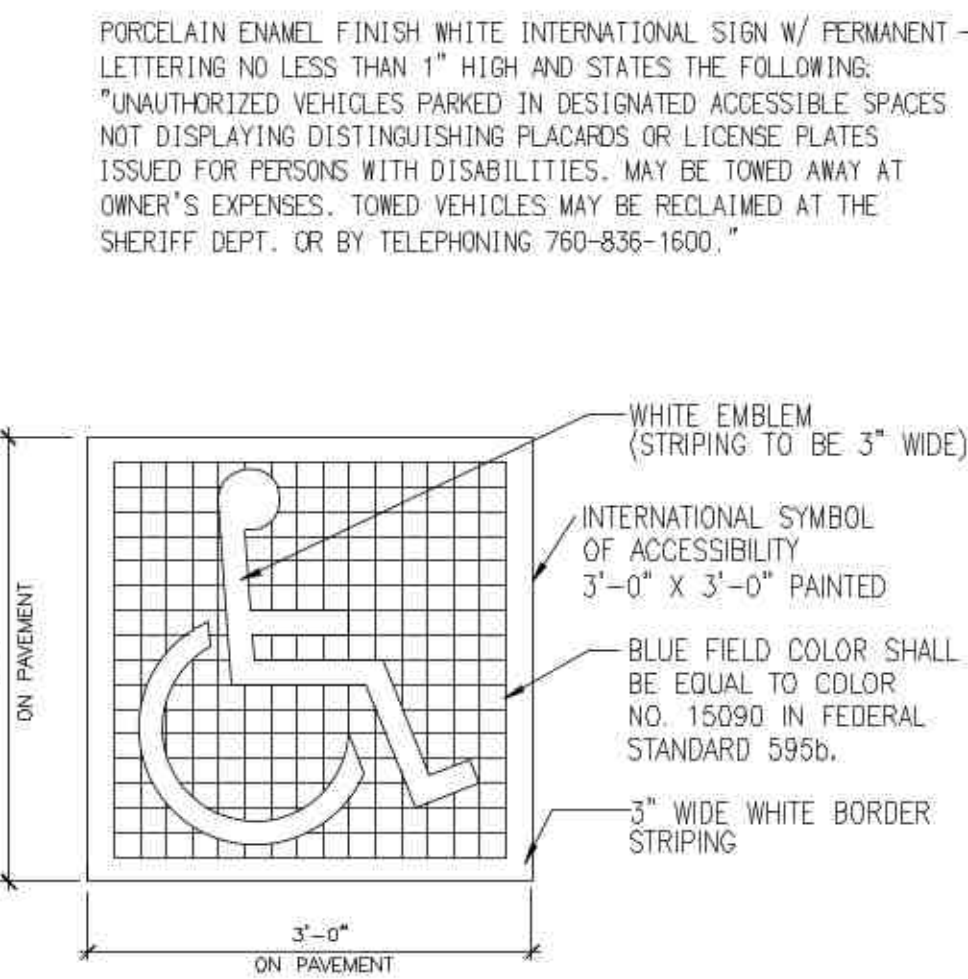

ACCESSIBLE PARKING SYMBOL-N.T.S.

NOTE: GRID LINES ARE SHOWN FOR PROPORTION ONLY AND ARE NOT TO APPEAR AS PART OF SYMBOL. SYMBOL SHALL BE LOCATED SO THAT IT IS VISIBLE TO A TRAFFIC ENFORCEMENT OFFICER WHEN A VEHICLE IS PARKED IN THE SPACE.

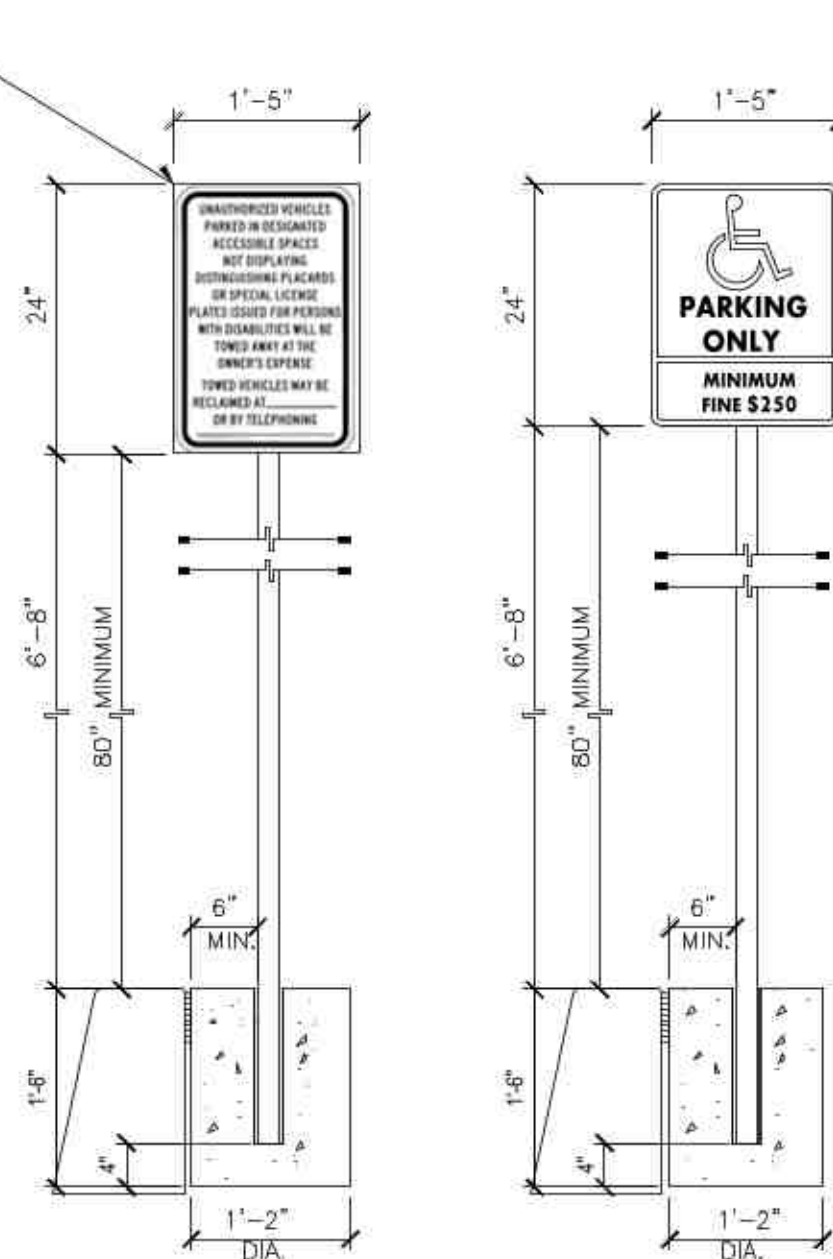

DISABLED PARKING SIGN-N.T.S.

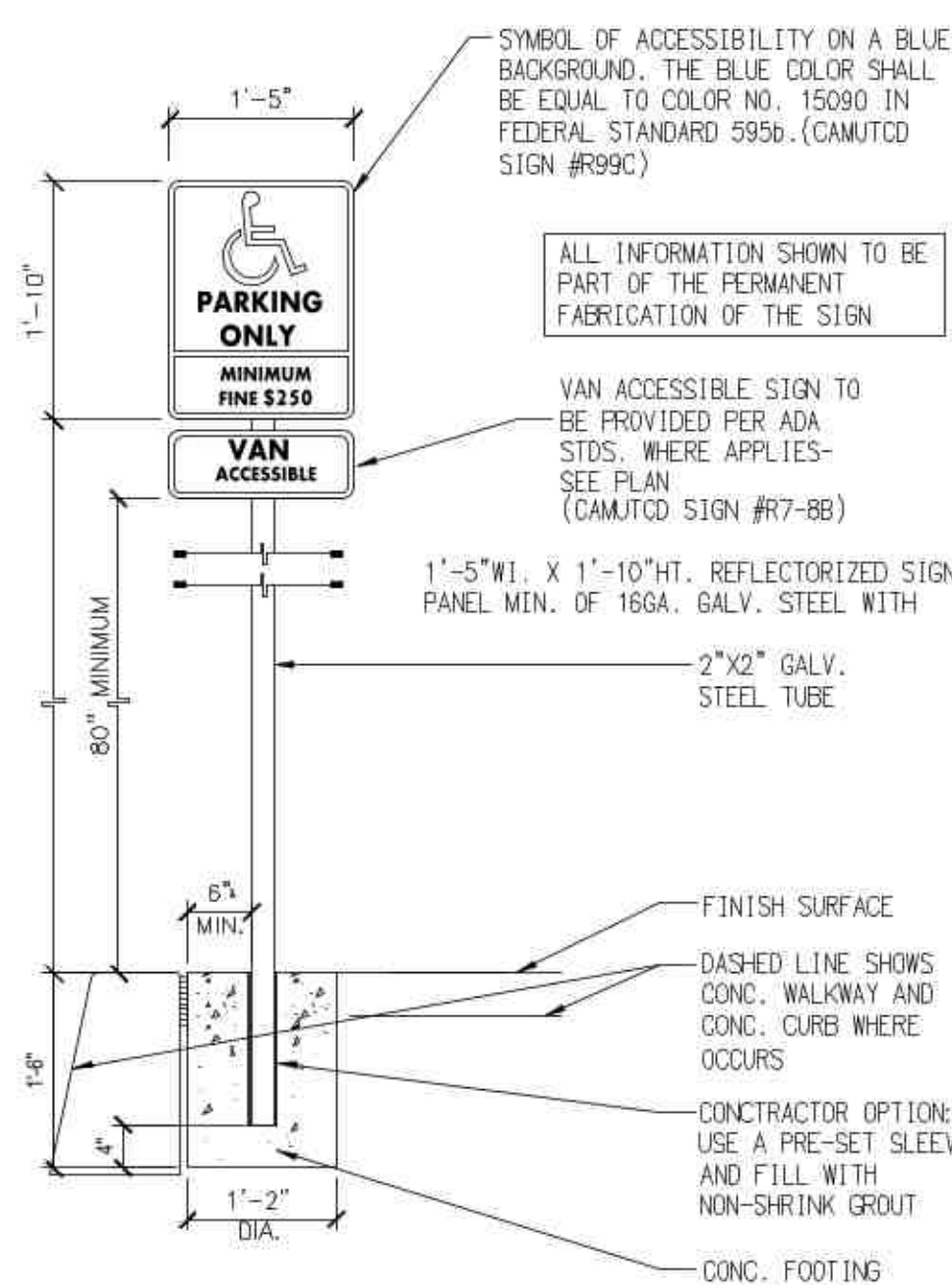

ACCESSIBLE ROUTE SIGN-N.T.S.

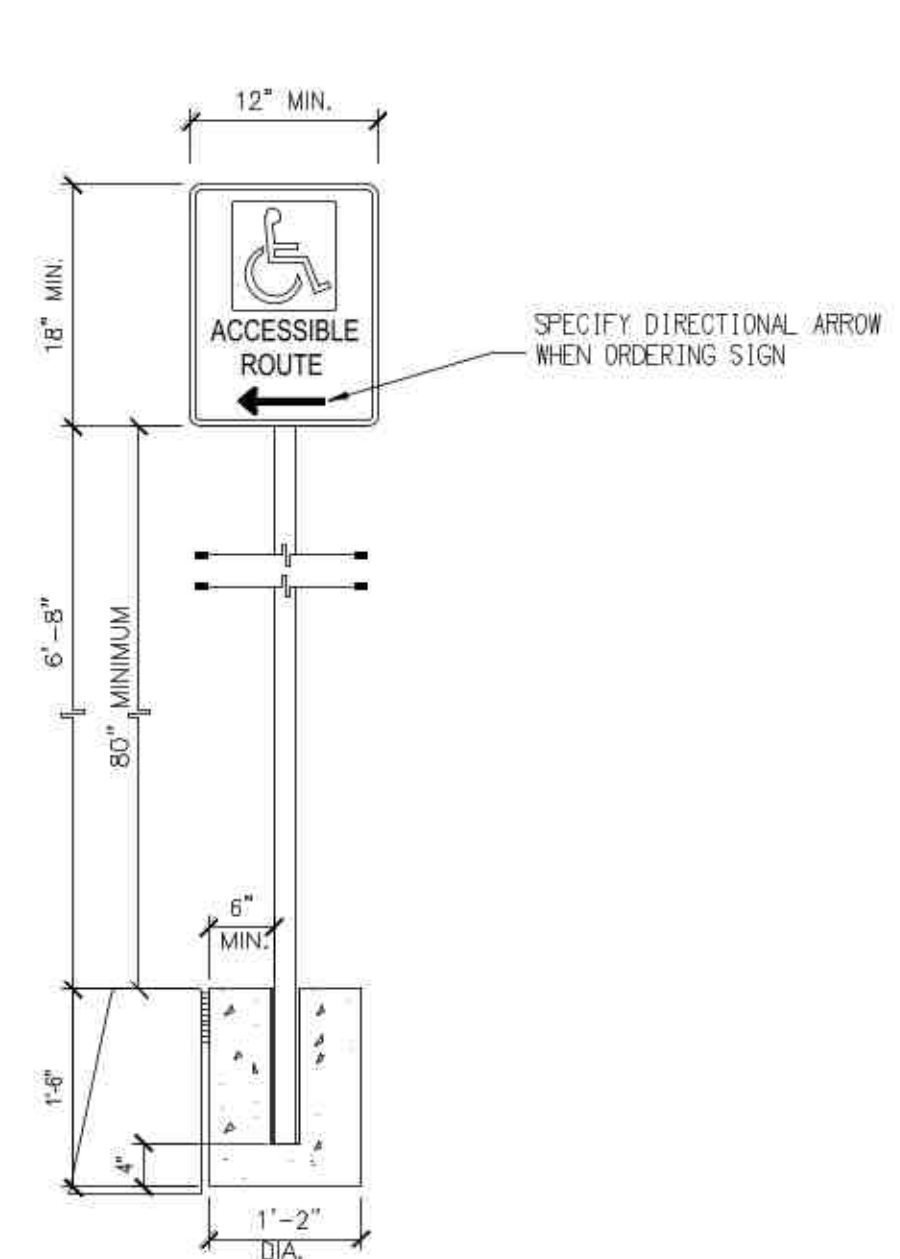

4 ACCESSIBLE PARKING SIGNS AND SYMBOL (ON PAVEMENT)

NOT TO SCALE

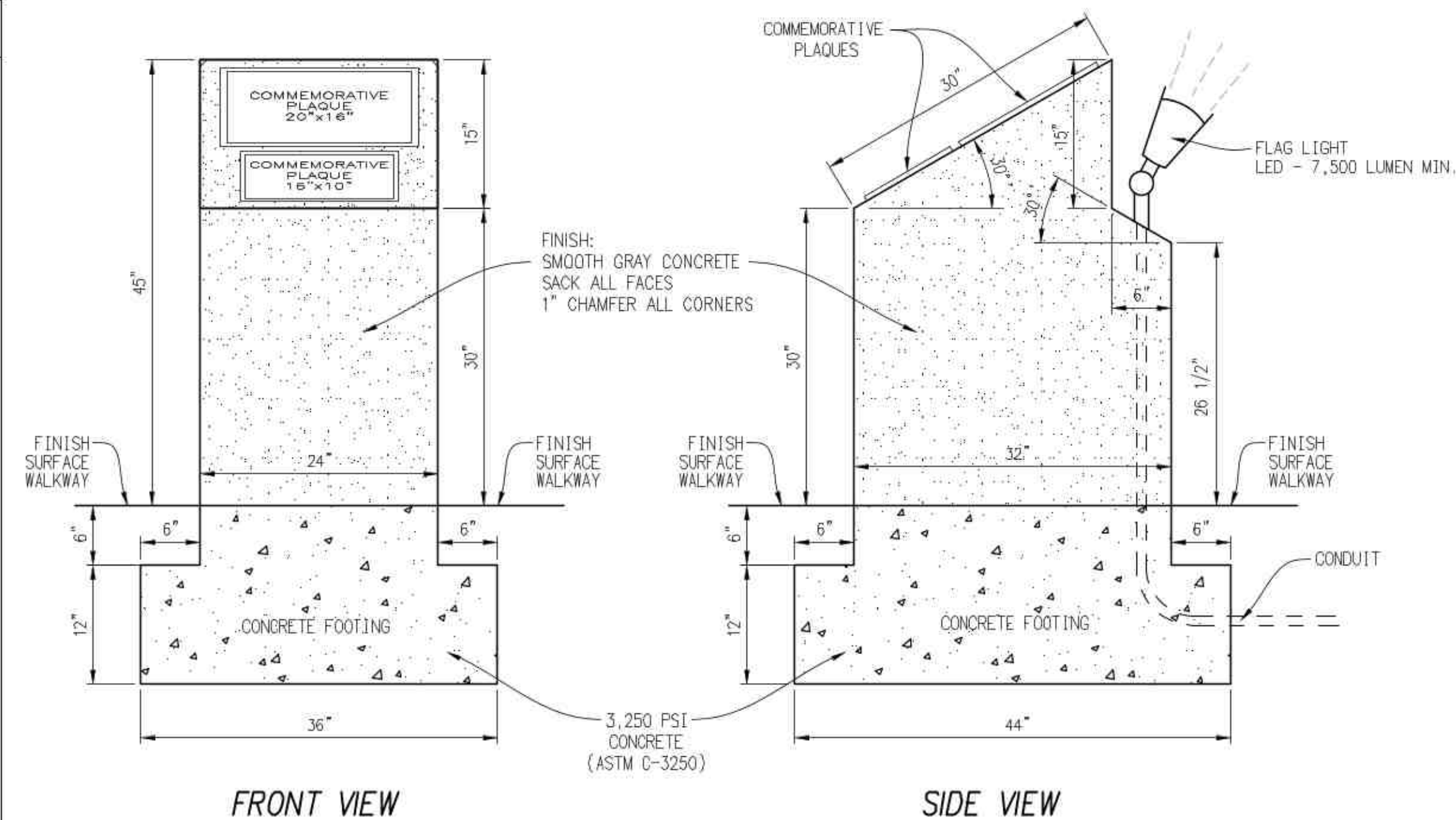

FRONT VIEW

SIDE VIEW

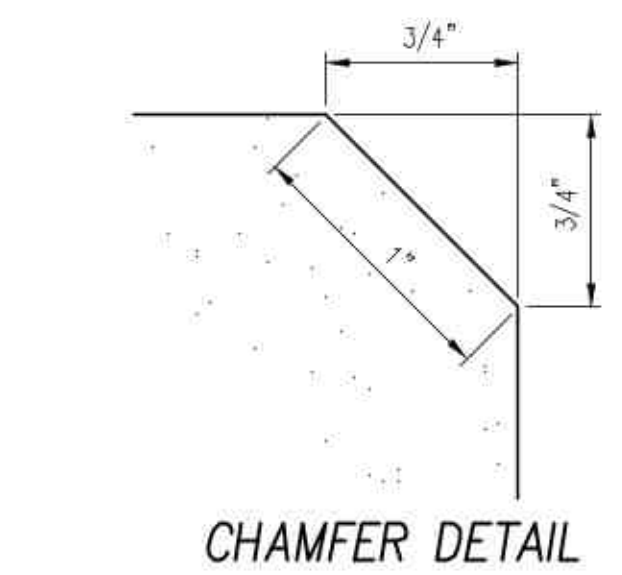

CHAMFER DETAIL

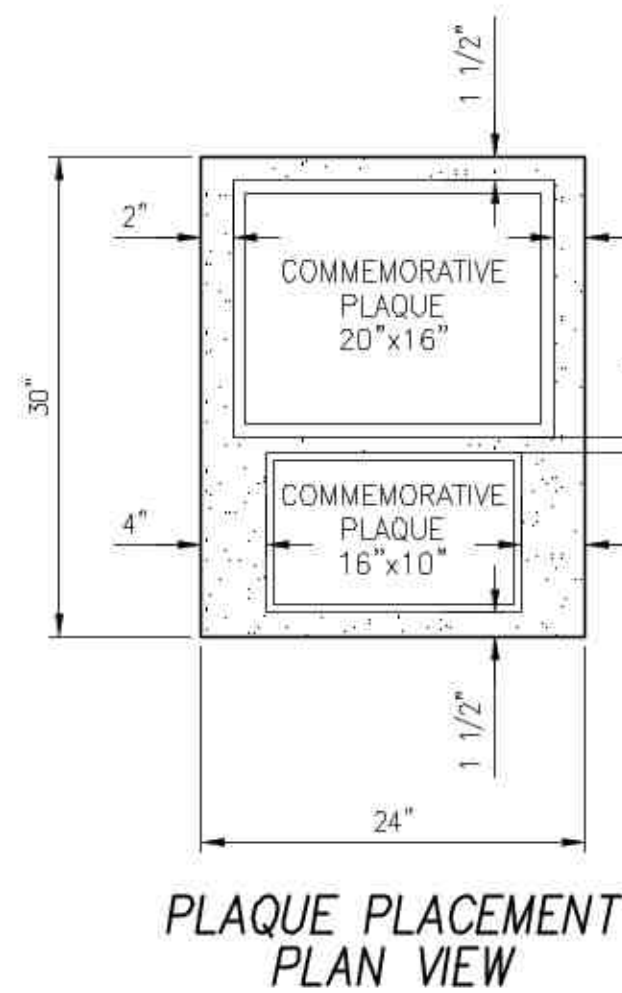

PLAQUE PLACEMENT PLAN VIEW

5 PEDESTAL FOR COMMEMORATIVE PLAQUES WITH FLAG LIGHT

NOT TO SCALE

DIG ALERT
811
AT LEAST TWO DAYS BEFORE YOU DIG UNDERGROUND SERVICE ALERT OF SOUTHERN CALIFORNIA

BENCHMARK PD BM #141
ELEVATION 185.78
DATUM NAVD 88

LOCATION 2" BRASS DISK ON CURB OF RIDGE VIEW WAY ISLAND AT PCC STATION 16+78.85 SHOWN ON CITY OF PALM DESERT STREET & STORM DRAIN IMPROVEMENT PLANS FOR IRONWOOD COUNTRY CLUB TRACT NO. 29713, SHEET B OF 17 ON FILE IN THE OFFICE OF CITY ENGINEER OF THE CITY OF PALM DESERT AS PLAN NO. E-875-B.

BASIS OF BEARINGS
BEARINGS SHOWN HEREON ARE BASED ON THE CENTERLINE OF RIDGE VIEW WAY OF TRACT NO. 29713, AS SHOWN BY A MAP ON FILE IN BOOK 349, PAGES 12 THROUGH 22 INCLUSIVE OF MAPS, RECORDS OF THE COUNTY OF RIVERSIDE, STATE OF CALIFORNIA, BEING: NORTH 39°26'02" WEST

ENGINEER	MARK	BY	DATE	REVISIONS	CITY	APPR.	DATE

DESIGNED BY BDE
DRAWN BY SPE
CHECKED BY BDE

BENJAMIN DANIEL EGAN
REGISTERED PROFESSIONAL ENGINEER
NO. 73070
STATE OF CALIFORNIA

EGAN CIVIL, INC.
PO BOX 5282 LA QUINTA, CA 92248-5282
(760) 404-7663 WWW.EGANCIVIL.COM

PREPARED UNDER THE DIRECT SUPERVISION OF:
BENJAMIN DANIEL EGAN, R.C.E. NO. 73070 DATE 12/05/2023

CITY OF PALM DESERT
DEPARTMENT OF DEVELOPMENT SERVICES

APPROVED BY: MICHAEL S. ROWE, P.E.
CITY ENGINEER
R.C.E. 56069, EXP. 12/31/2024

REVIEWED AND RECOMMENDED BY: DATE

PLANNING CHECKED BY: CIVIL, TRAFFIC, LANDSCAPE

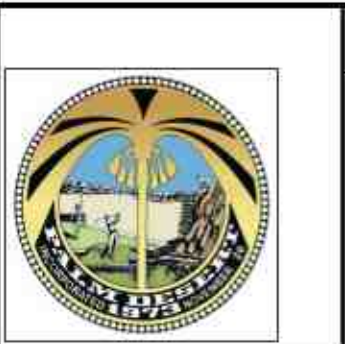

CITY OF PALM DESERT
73510 FRED WARING DRIVE, PALM DESERT, CA 92260
CIVIC CENTER ADA REVISIONS
DETAILS

PARCEL MAP NO. 37437 (MAP BOOK 245, PGS. 100-110)

SHEET 4 OF SHEETS 4
CITY FILE NUMBER MPL00001